

## Master Sensor

Master sensor to work with Power Supplies.

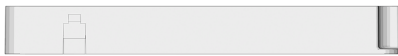
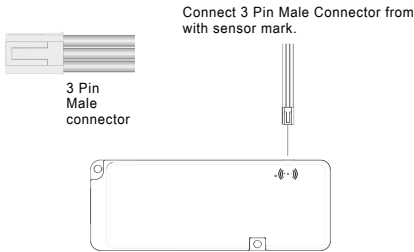

Master sensor port is located at longside of Power Supplies.

## Channel Sensor

Channel sensor comes with DuPont 2.54 male connector to work with Female connector on the power supplies.

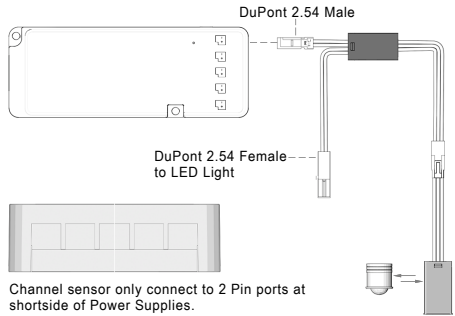
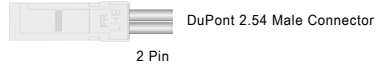

Channel sensor only connect to 2 Pin ports at shortside of Power Supplies.

▲ Please do not use master sensor and channel sensor at the same time ; functions may conflict.

## Sensor Types



Door Sensor

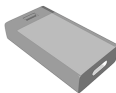

Motion Sensor



PIR Sensor



Touch On/Off Dimming Sensor

## Mount the sensor and power supplies

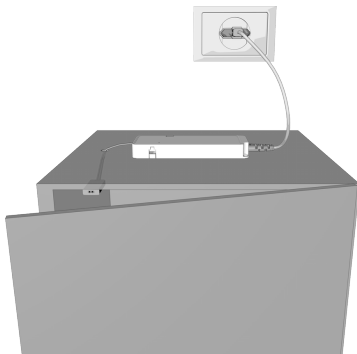

Mount the power supply on the top of the furniture.

### \*Motion Sensor and Door Sensor



Surface mounted installation by sticker

### \*PIR Sensor



Surface mounted by holder

Recessed

### \*Touch On/OFF Dimming Sensor



Recessed

### Door Sensor

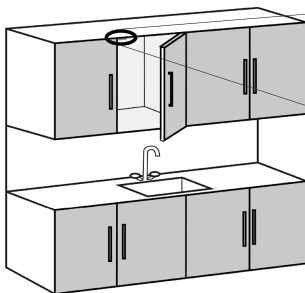

Turn on the light when the door is open; turn off when the door is closed.

### Motion Sensor

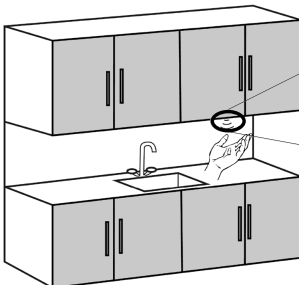
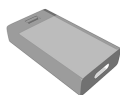

Single wave at front of the sensor to turn On / Off the lights. Detection range 10cm.

Avoid the sensor to be installed directly expose to sunshine.

### PIR Sensor

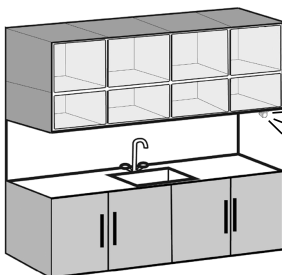

Turn On the lights when human body is detected. Turn Off the lights when no movement is detected over 30s.

### Touch Dimming Sensor

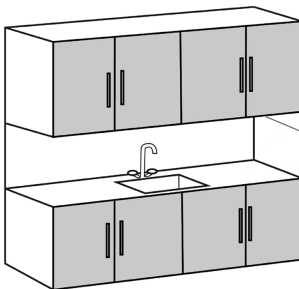

Single touch to turn On/Off Hold to select the brightness of light.

CHL, GORSE MILL, OL9 9RJ

EU Authorised Representative: Authorised Rep Compliance,  
Ground Floor, 71 Lower Baggot Street, Dublin, Ireland,  
D02P593.



Waste electrical products should not be disposed of with household waste. Please recycle where facilities exist. Check with your Local Authority or local store for recycling advice.