

Levello 1st Fix Installation

Please read these instructions carefully before installation. Leave a copy for the user for future reference.

Important safety information

1. All products should be installed by a suitably qualified person, ensuring the installation conforms to the current Building Wiring Regulations.
2. This product is designed for connection to a 230V 50Hz supply.
3. An earth bonding terminal is provided.
4. Always isolate the mains supply before servicing, fitting or replacing lamps and luminaries.
5. Always check that the lamp is correct for the application, including its wattage and voltage.
6. Never exceed the maximum wattage.
7. Luminaries may be hot, allow to cool before touching.
8. Luminaries are not suitable for covering with thermal insulated material. Unless the appropriate hood is installed. (LE9070, LE9071, LE9072)
9. This product must have a minimum clearance of 50mm to any combustible material.
10. Ensure all connections are tight (including factory made), poor connections can cause overheating, arcing and may create a fire risk.
11. Levello IP rated products are IP65 rated and are protected against dust and jets of water. They are suitable for installation in a location containing a bath or a shower where water jets are likely. (IP65 luminaire are IP20 within the ceiling void)
12. Replacement lamps should always be like for like, if in doubt, consult us.
13. Connector allows up to 3x 1.5m² twin and earth cable can be used.

Installation overview

1. Select the required position for your Levello product ensuring the clearance shown are observed. Beware of joists, water pipes and electric cables.
2. Cut hole for Levello housing.
3. Connect housing earth to mains connector as per its installation instructions.
4. Insert housing into ceiling.
5. Finish ceiling.
6. Insert the fitting.



Step 1- Housing Installation-

be aware of joists, water pipes and electric cables.

Where ceiling will be skim-plastered

For finished or tape and joint ceilings

Into concrete



Tools Required- 62mm holesaw (LE9007).

OR



Tools Required- Retrofit holesaw (LE9008).



Use Test Housing to check correct fit.

OR



Tools Required- 65mm holesaw. Ceiling will require skim-plastering.

Step 2-Electrical Installation

Remove fixing screws + cover. Strip cables back to the appropriate lengths outer 20mm/ inner 7mm. Offer cable into the terminal, ensuring there are no stray strands of wire. Screw tightly down onto the cables making sure the cable cannot be pulled out. Replace cover back onto the connector. Screw cover in place.

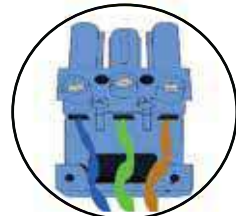

Connect the neutral, earth and live wires.



Connect the earth cable on housing to mains connector.



Insert housing. Make sure that the housing is properly seated and level.

Step 3- Finish Ceiling

Where ceiling will be skim-plastered

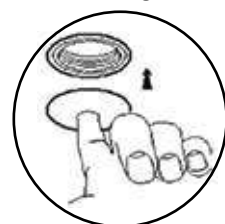

Insert plaster disk to protect housing.

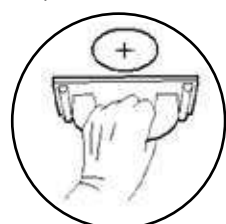

Plaster ceiling.

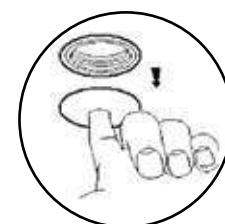

Remove plaster disk.

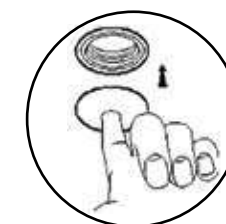

Insert painting disk.

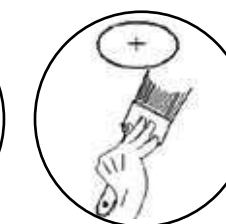

Paint ceiling.

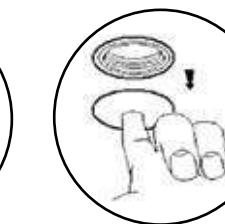

Remove paint disk, once paint is dry.

OR

Finished Ceiling-already finished ceiling or tape and joint

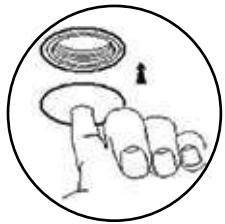

Insert plaster disk to protect housing.

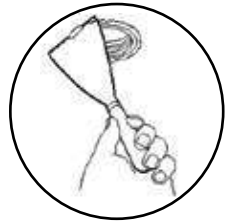

Fill ceiling.

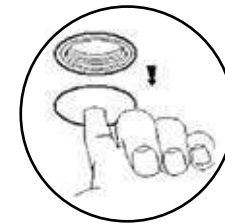

Remove plaster disk.

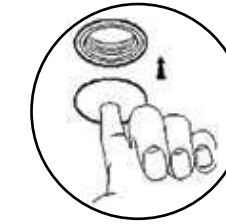

Insert painting disk.

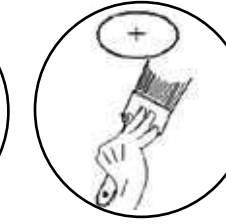

Paint ceiling.

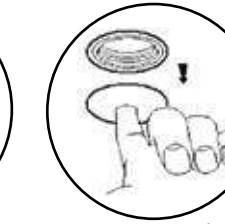

Remove paint disk, once paint is dry.

Levello 2nd Fix Installation

Please read these instructions carefully before installation.
 Leave a copy for the user for future reference.

Once installation of the housing has been complete (see **Levello housing installation**)
 You may insert fitting.



Low Profile



Place lamp in the recess of two magnets.

Deep, Directional, Plus Ranges

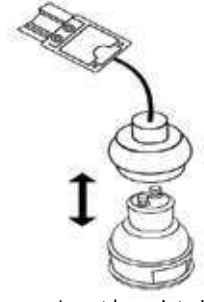

Insert lamp into insert.
 Make sure to clip the lamp retaining spring clip to secure the lamp.

OR

Note: Make sure that the Levello fittings are completely flush when inserted.

Paintable Plates

Once installation of the housing has been complete (see **Levello housing installation**)
 You may paint the front plate to match the ceiling.

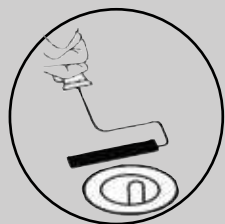

Using a clean surface, paint the front plate. Make sure that the IP protector is on the front plate before painting.

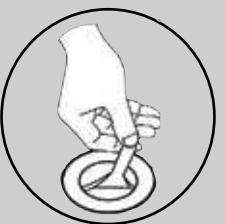

When paint is dry, you may remove the IP protector from the front plate.
Warning: please ensure that the paint is completely dry before removing the IP protection label.

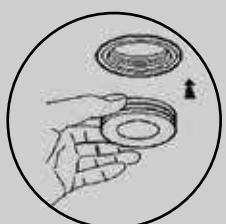

Then insert levello fitting in the housing in the ceiling.

Installation of Accessories (Baffles)

Deep and Directional insert

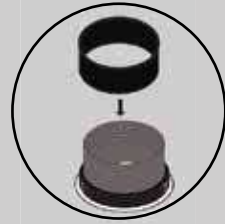

Place you desired colour baffle in the insert and place your lamp.

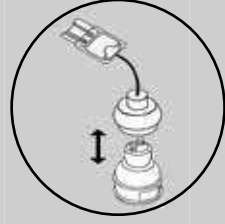

Clip the lamp retaining spring clip in the insert to secure the lamp.

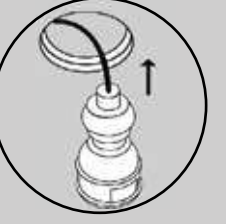

Insert Levello fittings in the housing.

Lamp Replacement

Care should be taken when working at heights

Low Profile

- 1) Remove Levello fitting
 - a. The fitting should be able to be removed with your fingers or Levello Magnetic Removal tool (LE9009), to take out the front plate and magnets if required.
 - b. In case of IP rated fittings a Levello Magnetic Removal Tool (LE9009) should be used (must be purchased separately).
 - c. Unplug the mains connector and take the assembly to your table.
- 2) Replace Lamp
 - a. Unplug lamp from lampholder.
 - b. Remove magnets around old lamp.
 - c. Re-assemble fitting as per **Low Profile** diagram.
- 3) Insert fitting
 - a. Connect fitting connector to mains connector.
 - b. Insert fitting into housing- ensuring that the front plate is seated correctly in the housing.

Deep, Directional, Plus Ranges

- 1) Remove Levello fitting
 - a. The fitting should be able to be removed with your fingers or Levello removal sucker, to take out the front plate and magnets if required.
 - b. In case of IP rated fittings a Levello removal sucker should be used (must be purchased separately)
 - c. Unplug the mains connector and take the assembly to your table.
- 2) Replace Lamp
 - a. Unplug lamp from lampholder.
 - b. Remove the spring clip holding the lamp in fitting.
 - c. Insert replacement lamp and fit lamp retaining spring clip.
 - d. Fit lamp in lampholder.
- 3) Insert fitting
 - a. Connect fitting connector to mains connector.
 - b. Insert fitting into housing- ensuring that the front plate is seated correctly in the housing.

LED Light Engine

Care should be taken when working at heights

Installation of LED Light Engine

Once installation of the housing has been complete (see **Levello housing installation**)

- 1) Insert LED Light Engine
 - a. Place the LED Light Engine in the recess of the two magnets as per **Low Profile** diagram.
 - b. Clip the lamp retaining spring clip in the insert to secure the LED Light Engine.
- 2) Insert fitting
 - a. Connect fitting connector to mains connector.
 - b. Insert fitting into housing-ensuring that front plate is seated correctly in the housing.

Replacement of LED Light Engine

- 1) Remove Levello fitting
 - a. The fitting should be able to be removed with your fingers or Levello removal sucker, to take out the front plate and magnets if required.
 - b. In case of IP rated fittings a Levello removal sucker should be used (must be purchased separately)
 - c. Unplug the mains connector and take the assembly to your table.
- 2) Replace LED Light Engine
 - a. Unplug LED Light Engine from lampholder.
 - b. Remove the spring clip holding the LED Light Engine in fitting.
 - c. Insert replacement LED Light Engine and fit lamp retaining spring clip.
 - d. Fit LED Light Engine in lampholder.
- 3) Insert fitting
 - a. Connect fitting connector to mains connector.
 - b. Insert fitting into housing- ensuring that the front plate is seated correctly in the housing.

Note: Only replace with Levello lamp.